

RRH SERIES

Specifications

Inquiry

- Relief valves prevent damage in case of overpressurisation
- Baked enamel finish for increased corrosion resistance
- Coated with corrosive resistant baked enamel
- Nickel-plated, floating center tube increases product life
- Hollow plunger allows for both pull and push forces



Cylinder ton	Stroke (mm)	Model Number	Max. Cylinder Capacity (kn)		Cylinder Effective Area (cm ²)		Oil Capacity (cm ³)	
			Advance	Retract	Advance	Retract	Advance	Retract
30	178	RRH-307	326	213	46.6	30.4	829	541
	258	RRH-3010	326	213	46.6	30.4	1202	784
60	89	RRH-603	576	380	82.3	54.2	733	482
	166	RRH-606	576	380	82.3	54.2	1366	900
	257	RRH-6010	576	380	82.3	54.2	2115	1393
95	38	RRH-1001	931	612	133.0	87.4	505	333
	76	RRH-1003	931	612	133.0	87.4	1011	666
	153	RRH-1006	931	612	133.0	87.4	2035	1337
	257	RRH-10010	931	612	133.0	87.4	3420	2246
145	203	RRH-1508	1429	718	204.1	102.6	4144	2083

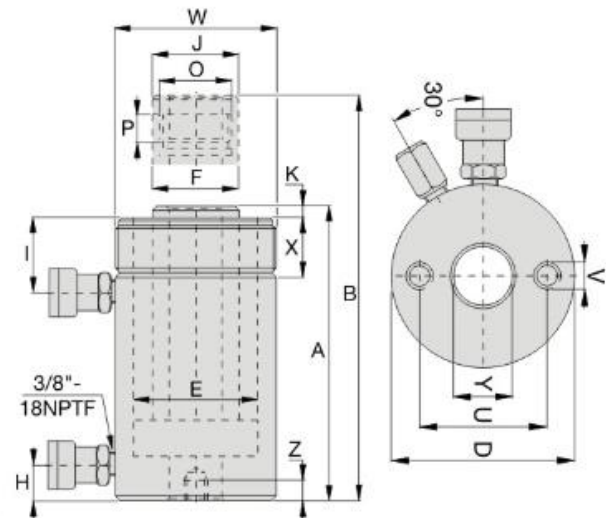

Coll. Height A (mm)	Ext. Height B (mm)	Out. Dia. D (mm)	Cyl. Bore Dia. E (mm)	Plgr. Dia. F (mm)	Cyl. Base to Adv. Port H (mm)	Cyl. Top to Return Port I (mm)	Saddle Dia. J (mm)	Saddle Protr. fr. Plgr. K (mm)	Thread O	Plunger Thread Length P (mm)	Collar Thread W	Collar Thread Length X (mm)	Center Hole Dia. Y (mm)	Weight (kg)	Model
330	508	114	88.9	63.5	25	60	63	9	1 ¹³ / ₁₆ "-16	22	4 ¹ / ₂ "-12	42	33.3	21	RRH-307
431	689	114	88.9	63.5	25	60	63	9	1 ¹³ / ₁₆ "-16	22	4 ¹ / ₂ "-12	42	33.3	27	RRH-3010
247	336	159	123.9	91.9	31	66	91	12	2 ³ / ₄ "-16	19	6 ¹ / ₄ "-12	48	53.8	28	RRH-603
323	489	159	123.9	91.9	31	66	91	12	2 ³ / ₄ "-16	19	6 ¹ / ₄ "-12	48	53.8	35	RRH-606
438	695	159	123.9	91.9	31	66	91	12	2 ³ / ₄ "-16	19	6 ¹ / ₄ "-12	48	53.8	45	RRH-6010
165	203	212	165.1	127.0	38	44	126	12	4"-16	25	-	-	79.2	33	RRH-1001
254	330	212	165.1	127.0	38	85	126	12	4"-16	25	8 ³ / ₈ "-12	60	79.2	61	RRH-1003
342	495	212	165.1	127.0	38	85	126	12	4"-16	25	8 ³ / ₈ "-12	60	79.2	79	RRH-1006
460	717	212	165.1	127.0	38	85	126	12	4"-16	25	8 ³ / ₈ "-12	60	79.2	106	RRH-10010
349	552	247	190.5	152.4	38	60	127	4	4 ¹ / ₄ "-12	25	-	-	79.2	111	RRH-1508